

### 2010 Ford Focus 2.0L

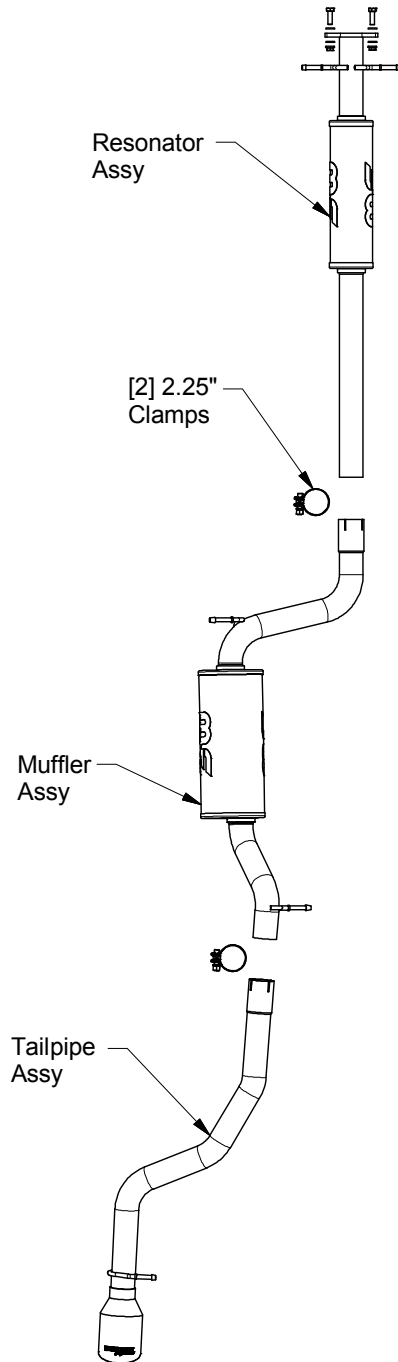

**Warning:** When working on, under, or around any vehicle exercise caution. Please allow the vehicle's exhaust system to cool before removal, as exhaust system temperatures may cause severe burns. If working without a lift, always consult vehicle manual for correct lifting specifications. Always wear safety glasses and ensure a safe work area. Serious injury or death could occur if safety measures are not followed.

**Step 1:** Begin removing your OEM exhaust system by unbolting the front flange located at the front of the vehicle behind the flex pipe. These front clamps will be re-used so it is necessary to twist the clamps to break the tack weld. Working front to rear detach all hangers from the rubber insulators. Retain the insulators and gasket as they will be used to install your new exhaust system. Remove the system from the vehicle.

**Step 2:** Install your new MAGNAFLOW system by first attaching the Resonator Assembly at the flange junction using the supplied 10mm fasteners. Next, slip the Muffler Assembly onto the Resonator Assembly and secure using the supplied 2.25" clamp. Finish by installing the Tailpipe Assembly in a similar fashion. Locate all hangers into the rubber insulators.

**Step 3:** With all components mounted loosely, adjust the system for overall aesthetics and clearance of frame & bodywork. (MAGNAFLOW recommends at least 1/2" of clearance between the exhaust system and any body panels to prevent heat-related body damage or fire.)

**Step 4:** Once a final position has been chosen for the new system, evenly tighten all fasteners from front to rear. The supplied band clamps must be VERY tight to properly align the pipes and prevent leaks (Approximately 40ft-lbs). Inspect all fasteners after 25-50 miles of operation and retighten if necessary.

**\*\* Magnaflow Performance Exhaust recommends professional installation on all their products**