

1999–2003 FORD F-SERIES – V8 7.3L, CREW CAB / EXT. CAB

DIAGRAM 1

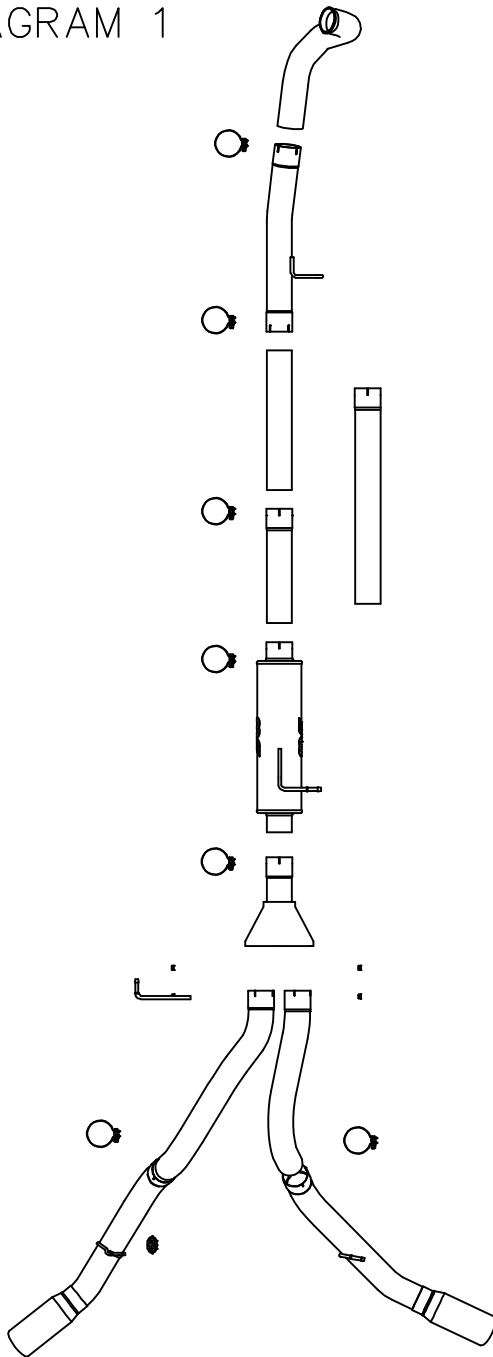

Note: MAGNAFLOW advises against the removal of catalytic converters. If the vehicle was originally equipped with a catalytic converter, this exhaust system is intended for off-road and racing applications only.

Warning: When working on, under, or around any vehicle exercise caution. Please allow the vehicle's exhaust system to cool before removal, as exhaust system temperatures may cause severe burns. If working without a lift, always consult vehicle manual for correct lifting specifications. Always wear safety glasses and ensure a safe work area. Serious injury or death could occur if safety measures are not followed.

Step 1: (Carefully read all instructions before installation) Disconnect the vehicle's battery before removal of the OEM exhaust. This will allow the computer to reset itself with the new system, and prevent electrical accidents. Cut the OEM exhaust system in front of the transmission crossmember. Remove the clamp from the turbo-downpipe connection, but do not discard, as it will be reused. Remove the system from the vehicle, taking care not to damage the rubber insulators. You may need to cut the extension pipe in front of the muffler to aid in removal of the OEM system.

Step 2: Begin installation of the new system by fastening the new downpipe to the turbo reusing the OEM V-band clamp. Leave all fasteners and clamps loose for final adjustment of the complete system. Working rearwards, install the extension pipes as needed using the supplied clamps. The 34" pipe is for Crew Cab Long Bed models, and the 18" pipe is for Crew Cab Short Bed and Extended Cab Long Bed models. Other models may require trimming of an extension pipe. Install the muffler and tailpipes in the same fashion using the supplied clamps and hanger assembly. The driver's hanger clamp is approximately .50" shorter than the passenger's hanger clamp on the barbed end. See Diagram 2 for installation of the hanger assembly.

***MAGNAFLOW Performance Exhaust recommends professional installation on all their products**

Technical support: 1-800-959-9226 ext. 4500

MAGNAFLOW Performance Exhaust – 22961 Arroyo Vista – Rancho Santa Margarita, CA 92688

1999–2003 FORD F–SERIES – V8 7.3L, CREW CAB / EXT.
CAB

DIAGRAM 2



Note: MAGNAFLOW advises against the removal of catalytic converters. If the vehicle was originally equipped with a catalytic converter, this exhaust system is intended for off-road and racing applications only.

Warning: When working on, under, or around any vehicle exercise caution. Please allow the vehicle's exhaust system to cool before removal, as exhaust system temperatures may cause severe burns. If working without a lift, always consult vehicle manual for correct lifting specifications. Always wear safety glasses and ensure a safe work area. Serious injury or death could occur if safety measures are not followed.

Step 3: With all components mounted loosely, adjust the system for overall aesthetics and clearance of frame & bodywork. (MAGNAFLOW recommends at least 1/2" of clearance between the exhaust system and any body panels to prevent heat-related body damage or fire.)

Step 4: Once a final position has been chosen for the new system, evenly tighten all fasteners from front to rear. Inspect all fasteners after 25-50 miles of operation and retighten if necessary.

***MAGNAFLOW Performance Exhaust recommends professional installation on all their products**

Technical support: 1-800-959-9226 ext. 4500

MAGNAFLOW Performance Exhaust – 22961 Arroyo Vista – Rancho Santa
Margarita, CA 92688